

TEATRO DI SAN CARLO
FONDAZIONE
DIREZIONE DEGLI ALLESTIMENTI SCENICI

PROGETTO ESECUTIVO	
PAVIMENTAZIONE SALE BALLO	
RAPPORTO	RAPP. 1:100

Napoli 16.06.2019

Sale da ballo (Tav. 1)

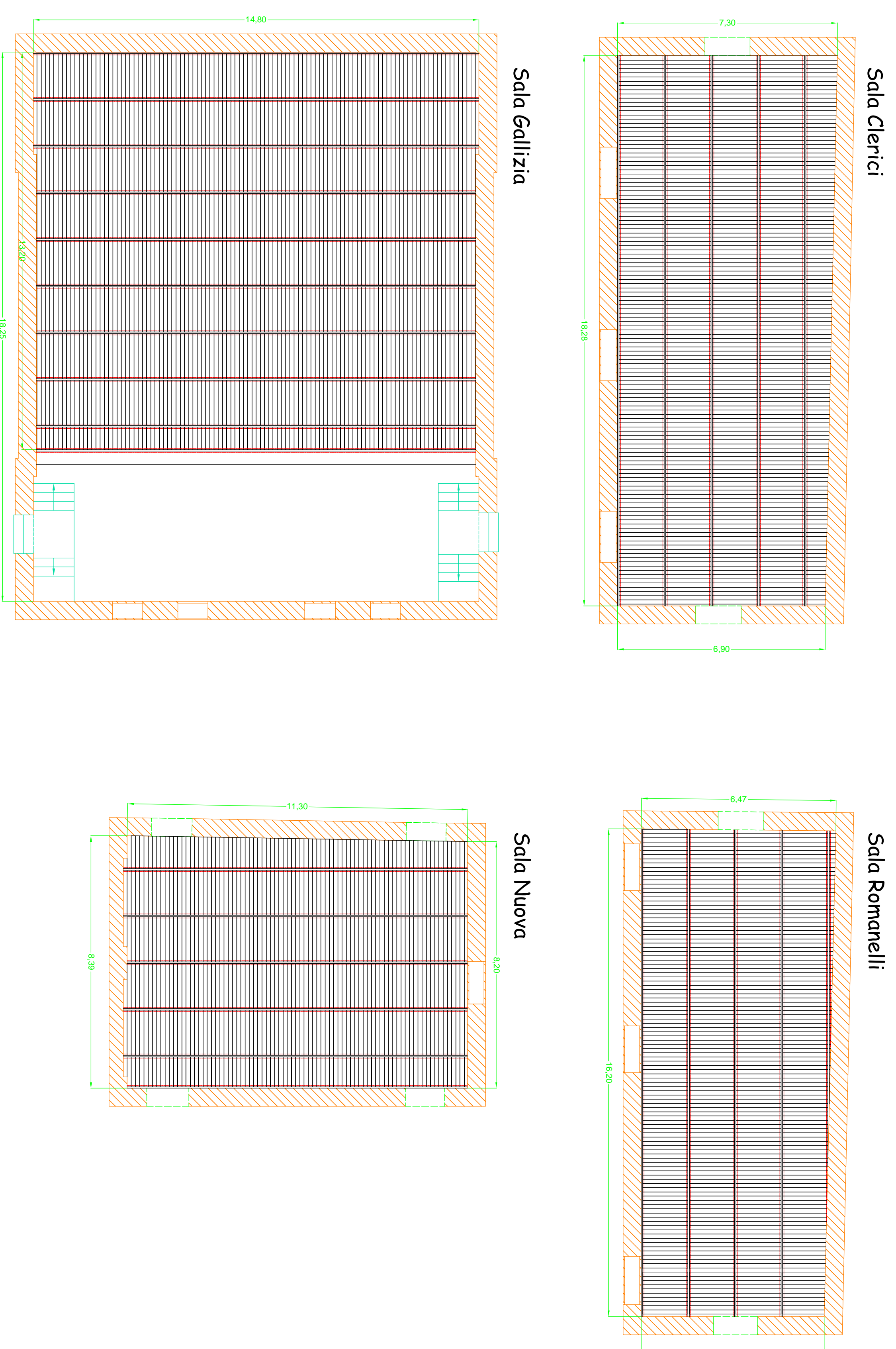

Particolari 1:1

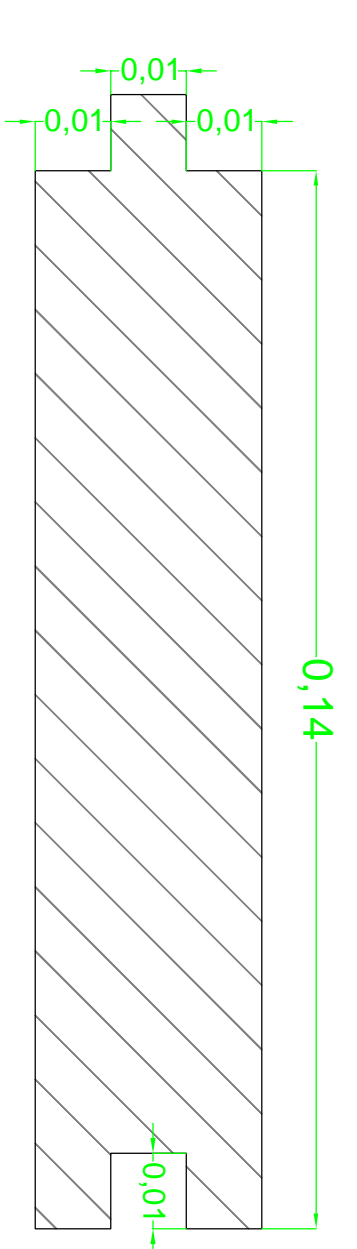

Particolari 1:20

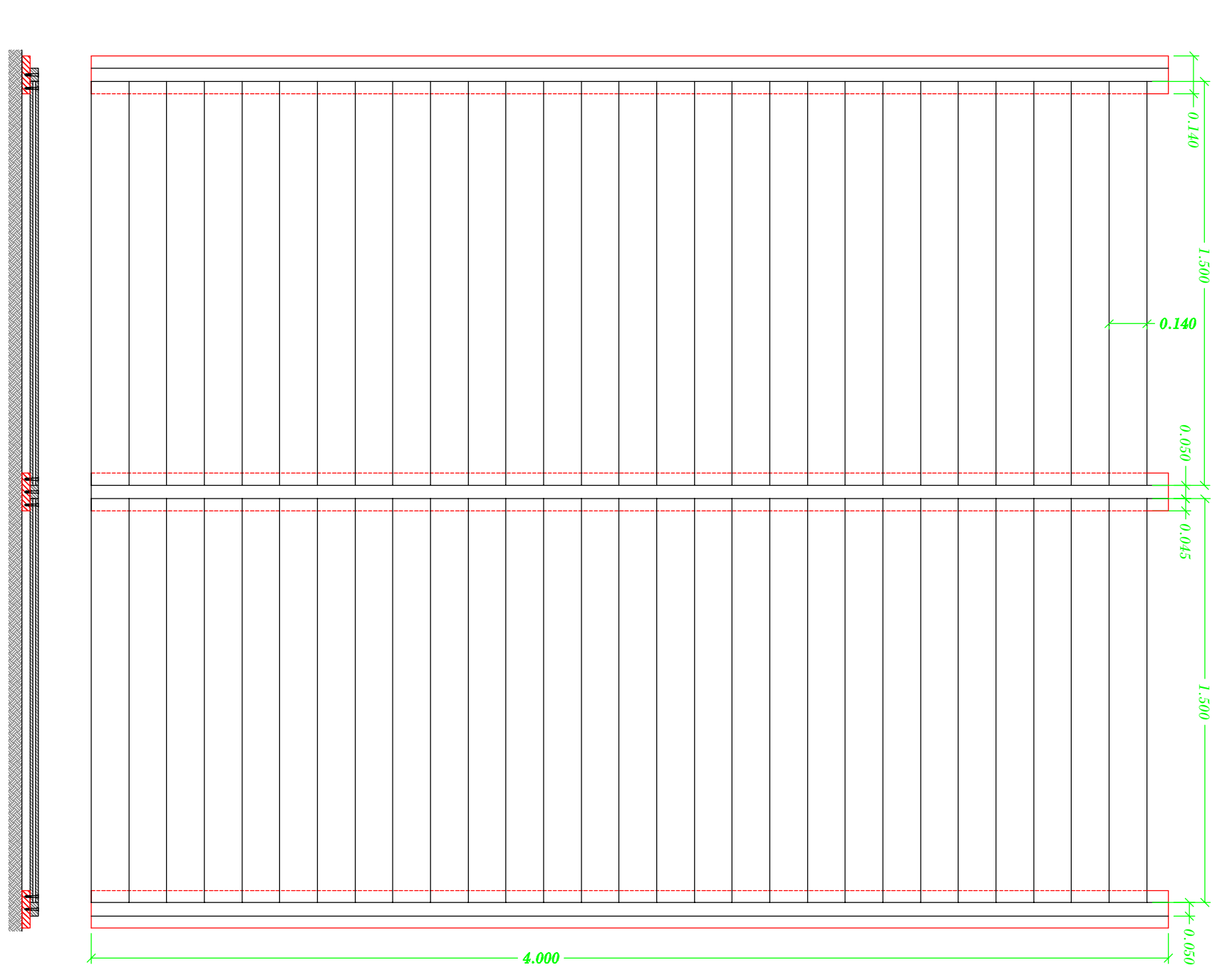

Particolare tappeto no scala (Tav.3)

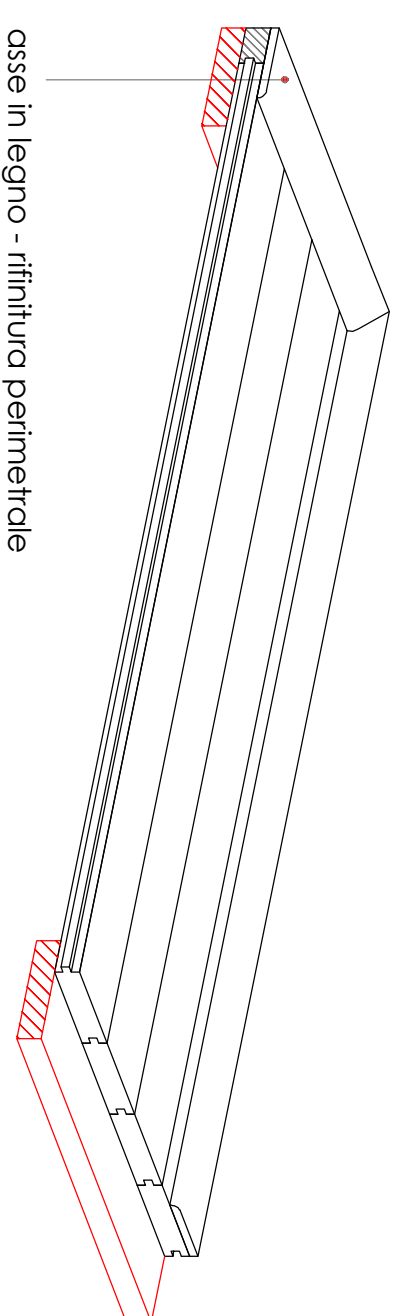

Particolari 1:10 (Tav.2)

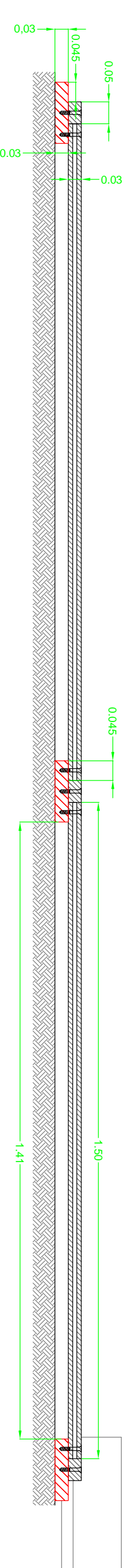

Particolari no scala

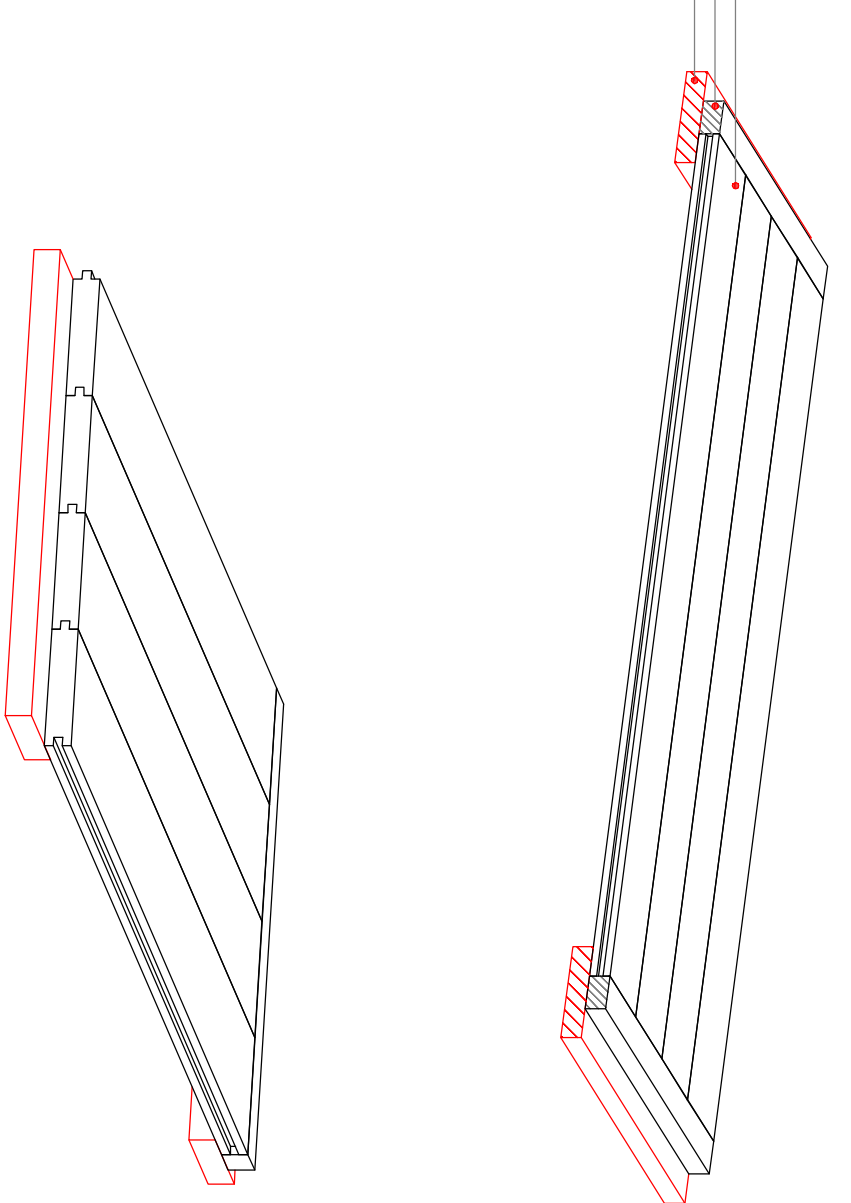

Particolare scivolo - Sala Gallizia (Tav.4) 1:10

